

Santa EULÀLIA

DE LES CASES DE POSADA

(NAVÈS)

NAVÈS







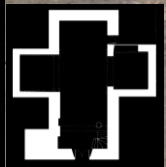

2009



capella

sagrastia

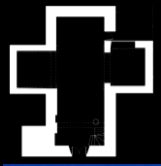



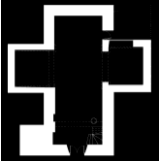







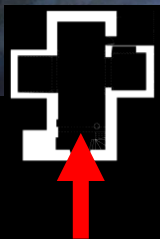



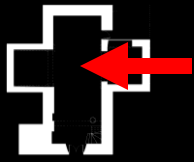



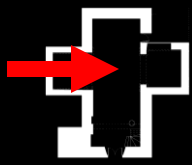

era l'entrada a la sagristia (no original)

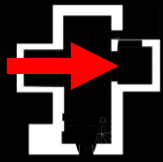

2009



2009



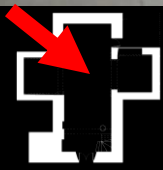



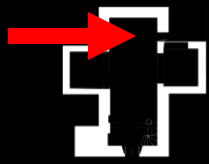

cor – pujada al campanar





des del cor

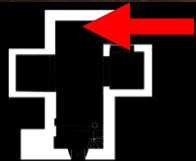

cor – baixada

des del cor :
baixada









Image © 2013 Institut Cartogràfic de Catalunya

Google earth

Fecha de las imágenes: 1/1/2009 42°06'35.71" N 1°35'57.24" E elev. 826 m

E (X): 384191.0 m - N (Y): 4662929.0 m - H: 825 m UTM 31N / ETRS89
E (X): 384284.6 m - N (Y): 4663132.9 m - H: 825 m UTM 31N / ED50

10 m



FI DE LA PRESENTACIÓ

Sortiu amb ESC